



REAL ESTATE UNIT :LEASE ON ERF 2586 OF MOBENI
(WARRINGTON /LEICESTER ROADS)
29104-7E CONTRACT NUMBER

REQUEST FOR PROPOSAL FOR THE LONG-TERM LEASING AND DEVELOPMENT OF ERF 2586 MOBENI, MEASURING 1969 SQUARE METRES AS DREPICTED ON SJ Plan No. 4744/6A FOR COMMERCIAL PURPOSES FOR A PERIOD NOT EXCEEDING 9 YEARS AND 11 MONTHS.



REAL ESTATE UNIT

REQUEST FOR PROPOSAL FOR THE LONG-TERM LEASING AND DEVELOPMENT OF ERF 2586 MOBENI, MEASURING 1969 SQUARE METRES AS DREPICTED ON SJ Plan No. 4744/6A FOR COMMERCIAL PURPOSES FOR A PERIOD NOT EXCEEDING 9 YEARS AND 11 MONTHS. (WARRINGTON ROAD/LEICESTER ROADS)

eThekweni Metropolitan Municipality hereby request proposals from interested persons to submit for the long term leasing of Erf 2586 Mobeni as depicted SJ plan No.4744/6A measuring 1969 m².

THIS DOCUMENTS OF 58 PAGES, IT IS THE RESPONSIBILITY OF THE TENDERER / BIDDER TO SEE THAT ALL PAGES ARE INCLUDED IN THE DOCUMENT.

Name of Bidder _____

DOCUMENTS TO BE SUBMITTED: 1 ORIGINAL AND 2 COPIES

Closing date of the Bid 27/02/2026

Closing Time: 11:00

**Issued by: T.E. Mmusinyane
Director: Property Valuations and Management
4th Floor,
199 Anton Lembede Street**

REQUEST FOR PROPOSAL FOR THE LONG-TERM LEASING AND DEVELOPMENT OF ERF 2586 MOBENI, MEASURING 1969 SQUARE METRES AS DREPICTED ON SJ Plan No. 4744/6A FOR COMMERCIAL PURPOSES FOR A PERIOD NOT EXCEEDING 9 YEARS AND 11 MONTHS.

No	CONTENTS	PAGE
1.	TENDER ADVERT	4
2.	INVITATION TO BID (MDB 1)	6
3.	TERMS AND CONDITIONS FOR BIDDING (MDB 1.1)	7
4.	TAX CLEARANCE CERTIFICATE REQUIREMENTS (MDB 2)	8
5.	PRICING SCHEDULE: FINANCIAL OFFER (REU MDB 3.1)	9
6.	DECLARATION OF INTEREST (MDB 4)	10
7.	DECLARATION FOR PROCUREMENT ABOVE R10 MILLION (MDB 5)	13
8.	PREFERENCE POINTS CLAIM FORM IN TERMS OF THE PREFERENTIAL PROCUREMENT REGULATIONS 2017. (MDB 6.1)	14
9.	BIDDERS INFORMATION (MDB 7)	20
10.	DECLARATION OF BIDDER'S PAST SUPPLY CHAIN MANAGEMENT PRACTICES (MBD 8)	21
11.	CERTIFICATE OF INDEPENDENT BID DETERMINATION (MDB 9)	23
12.	STANDARD CONDITIONS OF SUBMISSION (MDB 10)	27
13.	EVALUATION CRITERIA (REU MDB 11)	32
14.	BID SPECIFICATION (REU MDB 12)	38
15.	PROPERTY INFORMATION (REU MDB 13)	42
16.	REGISTRATION DOCUMENTS (MDB 14)	45
17.	AUTHORITY TO SUBMIT BID (MBD 15)	46
18.	PAYMENT OF MUNICIPAL ACCOUNT (MBD 16)	47
19.	PROPOSAL FOR THE LEASE (REU MBD 17)	48
20.	SUSTAINABILITY MODEL (FUNDING/ DONOR/ SPONSOR) (REU 18)	50
21.	PUBLIC/SOCIAL BENEFIT PROPOSAL (MBD 19)	51
22.	PROPOSED EMPOWERMENT PLAN (MDB 20)	52
23.	REU MBD 21: EXPERIENCE AND CAPABILITIES OF BIDDER	53
24.	ACCESS TO FUNDING (MBD 21)	56
25.	ANNEXURE A : DEMOGRAPHIC PROFILE	57
26.	ETHEKWINI MUNICIPALITY COUNCIL'S DECISION DATED 29/04/2021	58

REQUEST FOR PROPOSAL FOR THE LONG-TERM LEASING AND DEVELOPMENT OF ERF 2586 MOBENI, MEASURING 1969 SQUARE METRES AS DREPICTED ON SJ Plan No. 4744/6A FOR COMMERCIAL PURPOSES FOR A PERIOD NOT EXCEEDING 9 YEARS AND 11 MONTHS.

TENDER ADVERT

REQUEST FOR PROPOSAL FOR THE LONG-TERM LEASING AND DEVELOPMENT OF ERF 2586 MOBENI, MEASURING 1969 SQUARE METRES AS DREPICTED ON SJ Plan No. 4744/6A FOR COMMERCIAL PURPOSES FOR A PERIOD NOT EXCEEDING 9 YEARS AND 11 MONTHS. (WARRINGTON ROAD/LEICESTER ROADS)

eThekwini Metropolitan Municipality, hereby invites interested persons to submit proposals for the leasing of the property stated hereunder:

BID NUMBER	TENDER DESCRIPTIONS	SITE SIZE
<u>29104-7E</u>	REQUEST FOR PROPOSAL FOR THE LONG-TERM LEASING AND DEVELOPMENT OF ERF 2586 MOBENI, MEASURING 1969 SQUARE METRES AS DEPICTED ON SJ Plan No. 4744/6A FOR COMMERCIAL PURPOSES FOR A PERIOD NOT EXCEEDING 9 YEARS AND 11 MONTHS. (WARRINGTON ROAD/LEICESTER ROADS)	1969m²
Non – compulsory briefing session	<p>There will be a clarification meeting.</p> <p>The first clarification meeting will be held on 11th November 2025 at 4th Floor Embassy Building from 9:30am to 12:30pm. The second clarification meeting will be held on 29th January 2026 at 4th Floor Embassy Building from 9:30am to 12:30pm. All questions and answers from the clarification meeting will be uploaded onto the eThekwini website by the 12th February 2026</p>	
Document Availability	31st October 2025	
Documents Cost	Document Cost: R0,00	
Objective criteria in terms of Paragraph 2(1)(f) of the Preferential Procurement Policy Framework Act 5 of 2000 is to give effect to Section 25 (5) of the Constitution of the Republic of South Africa	<p>In line with Section 25 (5) of the Constitution “The state must take reasonable legislative and other measures, within its available resources, to foster conditions which enable citizens to gain access to land on an equitable basis.”</p> <p>The objective criteria will be applied in the flowing manner:</p> <ol style="list-style-type: none"> 1) The demographic profile of property ownership or access to property will be assessed using the Municipality’s lease register in relation to the location of the subject property and the level of participation in the sector. Preference will be given to the most underrepresented groups within that property profile. The graph depicted under Annexure A on page 59 represents the current demographic profile of existing leases that would apply to this bid. <ul style="list-style-type: none"> • Bidders must score a minimum of 70 points for Functionality Evaluation in order to qualify for further evaluation in Price and Preference Goal and the Objective Criteria. 	
Mandatory Requirements in line with the requirements of Regulation 41 (4) of the Asset Transfer Regulations to ensure that the successful bidder has the ability to develop, maintain and safe guard	<p>Bidders are to provide a funding model to incorporate how and where funding will be sourced/raised, and it must include collateral to be pledged against such funding if required. The bidder is to demonstrate proof of availability of 100% of the funding required for the development. This must include written support from verifiable funding institutions/ expression of interest to fund.</p> <ul style="list-style-type: none"> • the letter from a registered funder with Financial Sector Conduct Authority (FSCA) reflecting the full amount of the development cost. • If there is a shortfall and the bidder shows how they will fund the shortfall. • Written confirmation from a registered funder with Financial Sector Conduct Authority (FSCA) confirming availability of equity funding to cover the full development cost. • If the AFS reflect cash and cash equivalents 	

REQUEST FOR PROPOSAL FOR THE LONG-TERM LEASING AND DEVELOPMENT OF ERF 2586 MOBENI, MEASURING 1969 SQUARE METRES AS DREPICTED ON SJ Plan No. 4744/6A FOR COMMERCIAL PURPOSES FOR A PERIOD NOT EXCEEDING 9 YEARS AND 11 MONTHS.

the capital asset.	
Selection Criteria	<p>Failure to meet the following requirements will invalidate the bid:</p> <ul style="list-style-type: none"> • Failure to meet mandatory requirements. • Any rental offer below the reserve price. • Bids that deviate from the tender specification; • Any proposal that does not include development of the land or the proposed usage is not in line with the zoning of the property. • Any development proposal that is outside the scope of this tender. • Non-commissioning of MBD 7 and non-signature of the Municipal Bidding Documents (MBD's). <p>NB: Failure to comply with the above will result in the bid not being evaluated for Stage 1 and Stage 2.</p>
Closing Date	27/02/2026
Conditions of submission of Request for Proposal	<ul style="list-style-type: none"> • Tax Clearance Certificate, valid on the closing date of the bid, or exemption to pay taxes as issued by the South African Revenue Services (SARS) or Valid Tax Compliant Verification PIN number issued by SARS. • Proof of registration of the Entity as follows: - Natural persons- certified copy of ID document/ passport - Partnership- copy of Partnership Agreement plus IDs of all partners - Company- current CM29 - Close Corporation- current copy of CK1 and/or CK2C - Trust- letter of appointment from the Master of the High Court of SA and deed of trust - Proof of registration of NPO or NGO (Copy of Provincial Registration Certificate etc.) • Up to date Municipal Account not older than three (3) months and not over three (3) months in arrears for the individual for all his/her properties/ Proof that acknowledgements or arrangements have been made to settle arrears / Affidavit stating why an up-to-date municipal account cannot be submitted for all the properties of the directors. • In the event the bidder is tendering as a Joint Venture/Consortium, all members of the JV/Consortium must submit all required documentation, a JV / Consortium agreement and a Joint Venture B-BBEE Certificate and the JV/Consortium agreement. • Completion and signature of all bid documents. • Central Supplier Data Base (CSD) registration.
Delivery Address	Ground floor Engineering Unit, Municipal Centre 166 K.E. Masinga Road (formerly Old Fort Road) DURBAN
Evaluation	Functionality, Rental Offer and Preference Goal of contributor using 80/20. 80 for rental value and 20 for Preference Goal status level of contributor

REQUEST FOR PROPOSAL FOR THE LONG-TERM LEASING AND DEVELOPMENT OF ERF 2586 MOBENI, MEASURING 1969 SQUARE METRES AS DREPICTED ON SJ Plan No. 4744/6A FOR COMMERCIAL PURPOSES FOR A PERIOD NOT EXCEEDING 9 YEARS AND 11 MONTHS.

MBD 1:

INVITATION TO BID

YOU ARE HEREBY INVITED TO BID FOR REQUIREMENTS OF THE (ETHEKWINI METROPOLITAN MUNICIPALITY)					
BID NUMBER	29104- (7E)	CLOSING DATE	27/02/2026	CLOSING TIME:	11:00
DESCRIPTION	REQUEST FOR PROPOSAL FOR THE LONG-TERM LEASING AND DEVELOPMENT OF ERF 2586 MOBENI, MEASURING 1969 SQUARE METRES AS DREPICTED ON SJ Plan No. 4744/6A FOR COMMERCIAL PURPOSES FOR A PERIOD NOT EXCEEDING 9 YEARS AND 11 MONTHS. (WARRINGTON ROAD/LEICESTER ROADS)				
THE SUCCESSFUL BIDDER WILL BE REQUIRED TO ENTER INTO A LEASE AGREEMENT WITH ETHEKWINI METROPOLITAN MUNICIPALITY.					

BID RESPONSE DOCUMENTS MUST BE DEPOSITED IN THE BID BOX SITUATED AT MUNICIPAL CENTRE, 166 K.E. MASINGA ROAD (formerly Old Fort Road) AND PLACED IN THE TENDER BOX LOCATED IN THE GROUND FLOOR FOYER.

SUPPLIER INFORMATION					
NAME OF BIDDER					
POSTAL ADDRESS					
STREET ADDRESS					
TELEPHONE NUMBER	CODE		NUMBER		
CELLPHONE NUMBER					
FACSMILE NUMBER	CODE		NUMBER		
EMAIL ADDRESS					
VAT REGISTRATION					
TAX COMPLIANCE STATUS	TCS PIN:		OR	CSD No:	
B-BBEE STATUS LEVEL VERIFICATION CERTIFICATE (TICK APPLICABLE BOX)		Yes	B-BBEE STATUS LEVEL SWORN AFFIDAVIT		Yes
		No			No
(A B-BBEE STATUS LEVEL VERIFICATION CERTIFICATE / SWORN AFFIDAVIT (FOR EMEs & QSEs) MUST BE SUBMITTED IN ORDER TO QUALIFY FOR PREFERENCE POINTS FOR B-BBEE)					
SIGNATURE OF BIDDER			DATE		
CAPACITY UNDER WHICH THIS BID SIGNED					
BIDDING PROCEDURE ENQUIRIES MAY BE DIRECTED TO:					

REQUEST FOR PROPOSAL FOR THE LONG-TERM LEASING AND DEVELOPMENT OF ERF 2586 MOBENI, MEASURING 1969 SQUARE METRES AS DREPICTED ON SJ Plan No. 4744/6A FOR COMMERCIAL PURPOSES FOR A PERIOD NOT EXCEEDING 9 YEARS AND 11 MONTHS.

By following link <https://rfq.durban.gov.za/jde/E1Menu.maf> prospective Service Providers will be able to view available (open) Tender opportunities without signing into the system. However, Service Providers will not be able to respond to a Tender without being signed into the system using a JDE User ID and Password.

5) Tender documentation

By accessing the **JDE System** (using <https://rfq.durban.gov.za/>) and viewing any available Tenders, prospective Service Providers will be able to download the relevant Tender documentation.

6) Submission of tender offers

Tender Offers are to be delivered, in “hard copy” format, to the Delivery Location as stated in the **Tender Conditions**.

In addition to the above, **Tender Offers are also to be SUBMITTED ELECTRONICALLY** (uploaded) on the eThekweni Municipality JDE System (Supplier Self Service (JDE-SSS) Module). **Notwithstanding the electronic submission**, a tender offer will only be deemed valid if the “hard copy” submission has been made. The “hard copy” submission will be deemed to be the ruling version.

Bidders are responsible for resolving all access rights and submission queries on the JDE System before the tender closing date/ time.

7) Viewing the Tender opening schedule

Users on the **JDE System** will be able to view the **Tender Opening Schedule** for each closed Tender. The tender opening schedule will also be made available on the eThekweni Municipal website at URL:

<https://www.durban.gov.za/pages/business/publication-of-received-bids>

Commented [A1]: Revised in v.12/05/2025.

Commented [A2]: Added in v.12/05/2025.

2. TAX COMPLIANCE REQUIREMENTS

2.1 BIDDERS MUST ENSURE COMPLIANCE WITH THEIR TAX OBLIGATIONS.

2.2 BIDDERS ARE REQUIRED TO SUBMIT THEIR UNIQUE PERSONAL IDENTIFICATION NUMBER (PIN) ISSUED BY SARS TO ENABLE THE ORGAN OF STATE TO VIEW THE TAXPAYER'S PROFITABLE AND TAX STATUS.

2.3 APPLICATION FOR THE TAX COMPLIANCE STATUS (TCS) CERTIFICATE OR PIN MAY ALSO BE MADE VIA E-FILING. IN ORDER TO USE THIS PROVISION, TAXPAYERS WILL NEED TO REGISTER WITH SARS AS E-FILERS THROUGH THE WEBSITE WWW.SARS.GOV.ZA.

2.4 FOREIGN SUPPLIERS MUST COMPLETE THE PRE-AWARD QUESTIONNAIRE IN PART 3 BELOW.

2.5 BIDDERS MAY ALSO SUBMIT A PRINTED TCS CERTIFICATE TOGETHER WITH THE BID.

2.6 IN BIDS WHERE CONSORTIA / JOINT VENTURES / SUB-CONTRACTORS ARE INVOLVED, EACH PARTY MUST SUBMIT A SEPARATE TCS CERTIFICATE / PIN / CSD NUMBER.

3. QUESTIONNAIRE TO BIDDING FOREIGN SUPPLIERS

3.1 IS THE ENTITY A RESIDENT OF THE REPUBLIC OF SOUTH AFRICA (RSA)?

YES NO

3.2 DOES THE ENTITY HAVE A BRANCH IN THE RSA?

YES NO

3.3 DOES THE ENTITY HAVE A PERMANENT ESTABLISHMENT IN THE RSA?

YES NO

REQUEST FOR PROPOSAL FOR THE LONG-TERM LEASING AND DEVELOPMENT OF ERF 2586 MOBENI, MEASURING 1969 SQUARE METRES AS DREPICTED ON SJ Plan No. 4744/6A FOR COMMERCIAL PURPOSES FOR A PERIOD NOT EXCEEDING 9 YEARS AND 11 MONTHS.

3.4 DOES THE ENTITY HAVE ANY SOURCE OF INCOME IN THE RSA?

YES NO

3.5 IS THE ENTITY LIABLE IN THE RSA FOR ANY FORM OF TAXATION?

YES NO

IF THE ANSWER IS "NO" TO ALL OF THE ABOVE, THEN IT IS NOT A REQUIREMENT TO REGISTER FOR A TAX COMPLIANCE STATUS SYSTEM PIN CODE FROM THE SOUTH AFRICAN REVENUE SERVICE (SARS) AND IF NOT REGISTER AS PER 2.3 ABOVE.

NB: FAILURE TO PROVIDE ANY OF THE ABOVE PARTICULARS MAY RENDER THE BID INVALID. NO BIDS WILL BE CONSIDERED FROM PERSONS IN THE SERVICE OF THE STATE.

SIGNATURE OF BIDDER:

CAPACITY UNDER WHICH THIS BID IS SIGNED:

DATE:

MBD 2

TAX CLEARANCE CERTIFICATE REQUIREMENTS

It is a condition of bid that the taxes of the successful bidder must be in order, or that satisfactory arrangements have been made with South African Revenue Service (SARS) to meet the bidder's tax obligations.

1 In order to meet this requirement bidders are required to complete in full the attached form TCC 001 "Application for a Tax Clearance Certificate" and submit it to any SARS branch office nationally. The Tax Clearance Certificate Requirements are also applicable to foreign bidders / individuals who wish to submit bids.

2 SARS will then furnish the bidder with a Tax Clearance Certificate that will be valid for a period of 1 (one) year from the date of approval.

3 The original Tax Clearance Certificate must be submitted together with the bid. Failure to submit the original and valid Tax Clearance Certificate will result in the invalidation of the bid. Certified copies of the Tax Clearance Certificate will not be acceptable.

4 In bids where Consortia / Joint Ventures / Sub-contractors are involved, each party must submit a separate Tax Clearance Certificate.

5 Copies of the TCC 001 "Application for a Tax Clearance Certificate" form are available from any SARS branch office nationally or on the website www.sars.gov.za.

6 Applications for the Tax Clearance Certificates may also be made via eFiling. In order to use this provision, taxpayers will need to register with SARS as eFilers through the website www.sars.gov.za.

REU MBD 3.4

PRICING SCHEDULE: FINANCIAL OFFER

1. This offer is made for the property in accordance with the Property Information stated in MBD 13 and in accordance with the bid specification in MBD 12.
2. **Unless stated otherwise all prices excludes VAT.**
3. **FINANCIAL OFFER**

A minimum / reserve amount of R 29 400,00 as per month Any offer below the RESERVED/ MINIMUM RENTAL will not be considered and such bids would accordingly be disqualified.	
Rental Offer	R
Escalation per annum and rental to be reviewed every five years	8%
Bidder / Entity Name	
Represented By	
Capacity	
Signature	

REQUEST FOR PROPOSAL FOR THE LONG-TERM LEASING AND DEVELOPMENT OF ERF 2586 MOBENI, MEASURING 1969 SQUARE METRES AS DREPICTED ON SJ Plan No. 4744/6A FOR COMMERCIAL PURPOSES FOR A PERIOD NOT EXCEEDING 9 YEARS AND 11 MONTHS.

Date	
-------------	--

OFFER TO BE VALID FOR 120 DAYS FROM THE CLOSING DATE OF BID.

eThekwini Vendor Portal Registration Number: PR

C.S.D Registration Number: MAAA

S.A.R.S Pin Number: _____

Completion of the following is compulsory. Failure to declare the following will invalidate your offer.

Declaration of Interest

Are any of the entity's directors, managers, principle shareholder or stakeholders currently in the service of the state or have been in the service of the state in the past twelve (12) months? <input type="checkbox"/> Yes <input type="checkbox"/> No				
Is any spouse, child or parent of the entity's directors, managers, principle shareholder or stakeholder currently in the service of the state or have been in the service of the state in the past twelve (12) months? <input type="checkbox"/> Yes <input type="checkbox"/> No				
Name of entity's member	Position in Entity	Name of Relative (if applicable)	Name of State Institution	Nature of Relationship
Do you or any other directors, managers, principle shareholder or stakeholder of your entity have any relationship (spouse, family, friend, associate) with persons in the service of the state and/or who may be involved with the evaluation of this quotation? If yes please furnish particulars below <input type="checkbox"/> Yes <input type="checkbox"/> No				
Name of entity's member	Position in Entity	Name of Relative (if applicable)	Name of State Institution	Nature of Relationship

OFFER TO BE VALID FOR 120 DAYS FROM THE CLOSING DATE OF BID.

4. PAYMENT FOR RATES, TAXES AND SERVICES

In addition to the above amount the lessee will be responsible for the payment of all municipal services and other costs deemed necessary on the property, including rates and taxes, electricity, water, sewerage and sanitation removal, which are levied on the property.

5. POSSESSION OF THE SITE

The lessee will take possession of the site on the date of signature of the Lease Agreement by the parties.

MBD 4: DECLARATION OF INTEREST

NOTES

MSCM Regulations: "in the service of the state" means to be:

- (a) a member of:
 - (i) any municipal council.
 - (ii) any provincial legislature.
 - (iii) the national Assembly or the national Council of provinces.
- (b) a member of the board of directors of any municipal enterprise.
- (c) an official of any municipality or municipal enterprise.
- (d) an employee of any national or provincial department, national or provincial public enterprise or constitutional institution within the meaning of the Public Finance Management Act, 1999 (Act No.1 of 1999).
- (e) a member of the accounting authority of any national or provincial public enterprise.
- (f) an employee of Parliament or a provincial legislature.

"Shareholder" means a person who owns shares in the company and is actively involved in the management of the company or business and exercises control over the company.

- 1 No bid will be accepted from persons **in the service of the state**.
- 2 Any person, having a kinship with persons **in the service of the state**, including a blood relationship, may make an offer or offers in terms of this invitation to bid. In view of possible allegations of favouritism, should the resulting bid, or part thereof, be awarded to persons connected with or related to **persons in service of the state**, it is required that the bidder or their authorised representative declare their position in relation to the evaluating/adjudicating authority and/or take an oath declaring his/her interest.
- 3 In order to give effect to the above, the following questionnaire must be completed and submitted with the bid.

3.1 Name of enterprise

Name of enterprise's representative

3.2 ID Number of enterprise's representative

3.3 Position enterprise's representative occupies in the enterprise

3.4 Company Registration number

3.5 Tax Reference number

3.6 VAT registration number

3.7 The names of all directors / trustees / shareholders / members / sole proprietors / partners in partnerships, their individual identity numbers and state employee numbers must be indicated in paragraph 4 below. In the case of a joint venture, information in respect of each partnering enterprise must be completed and submitted.

REQUEST FOR PROPOSAL FOR THE LONG-TERM LEASING AND DEVELOPMENT OF ERF 2586 MOBENI, MEASURING 1969 SQUARE METRES AS DREPICTED ON SJ Plan No. 4744/6A FOR COMMERCIAL PURPOSES FOR A PERIOD NOT EXCEEDING 9 YEARS AND 11 MONTHS.

3.8 Are you presently in the service of the state?

Circle
Applicable

YES	NO
-----	----

If yes, furnish particulars:

.....

.....

3.9 Have you been in the service of the state for the past twelve months?

If yes, furnish particulars:

YES	NO
-----	----

.....

.....

3.10 Do you have any relationship (family, friend, other) with persons in the service of the state and who may be involved with the evaluation and or adjudication of this bid?

YES	NO
-----	----

If yes, furnish particulars:

.....

.....

3.11 Are you, aware of any relationship (family, friend, other) between any other bidder and any persons in the service of the state who may be involved with the evaluation and or adjudication of this bid?

YES	NO
-----	----

If yes, furnish particulars:

.....

.....

3.12 Are any of the company's directors, trustees, managers, principle shareholders or stakeholders in service of the state?

YES	NO
-----	----

If yes, furnish particulars:

.....

.....

3.13 Are any spouse, child or parent of the company's directors, trustees, managers, principle shareholders or stakeholders in service of the state?

YES	NO
-----	----

If yes, furnish particulars:

.....

REQUEST FOR PROPOSAL FOR THE LONG-TERM LEASING AND DEVELOPMENT OF ERF 2586 MOBENI, MEASURING 1969 SQUARE METRES AS DREPICTED ON SJ Plan No. 4744/6A FOR COMMERCIAL PURPOSES FOR A PERIOD NOT EXCEEDING 9 YEARS AND 11 MONTHS.

.....

3.14 Do you or any of the directors, trustees, managers, principle shareholders, or stakeholders of this company have any interest in any other related companies or business whether or not they are bidding for this contract?

YES	NO
-----	----

If yes, furnish particulars:

.....

.....

4 The names of all directors / trustees / shareholders / members / sole proprietors / partners in partnerships, their individual identity numbers and state employee numbers must be indicated below. In the case of a joint venture, information in respect of each partnering enterprise must be completed and submitted.

Full Name	Identity No.	State Employee No.	Personal income tax No.
Use additional pages if necessary			

I, the undersigned, who warrants that they are authorised to sign on behalf of the Tenderer, confirms that the information contained in this form is within my personal knowledge and is to the best of my belief both true and correct.

NAME (Block Capitals):

Date

SIGNATURE:

.....

MBD 5: DECLARATION FOR PROCUREMENT ABOVE R10 MILLION
(ALL APPLICABLE TAXES INCLUDED)
(NOT APPLICABLE)

For all procurement expected to exceed R10 million (all applicable taxes included), bidders must complete the following questionnaire.

1.0 Are you by law required to prepare annual financial statements for auditing?

Circle Applicable	
YES	NO

1.1 If YES, submit audited annual financial statements for the past three years or since the date of establishment if established during the past three years.

2.0 Do you have any outstanding undisputed commitments for municipal services towards any municipality for more than three months or any other service provider in respect of which payment is overdue for more than 30 days?

YES	NO
-----	----

2.1 If NO, this serves to certify that the bidder has no undisputed commitments for municipal services towards any municipality for more than three months or other service provider in respect of which payment is overdue for more than 30 days.

2.2 If YES, provide particulars.

.....

3.0 Has any contract been awarded to you by an organ of state during the past five years, including particulars of any material non-compliance or dispute concerning the execution of such contract?

YES	NO	
-----	----	--

3.1 If YES, provide particulars.

.....

YES	NO
-----	----

4.0 Will any portion of goods or services be sourced from outside the Republic, and, if so, what portion and whether any portion of payment from the municipality / municipal entity is expected to be transferred out of the Republic?

4.1 If YES, provide particulars.

.....

If required by 1.1 above, tenderers are to include, at the back of their tender submission document, a printout of their audited annual financial statements.

I, the undersigned, who warrants that they are authorised to sign on behalf of the Tenderer, confirms that the information contained in this form is within my personal knowledge and is to the best of my belief both true and correct, and, if required, that the requested documentation has been included in the tender submission.

NAME (Block Capitals): _____ **Date** _____
SIGNATURE: _____

REQUEST FOR PROPOSAL FOR THE LONG-TERM LEASING AND DEVELOPMENT OF ERF 2586 MOBENI, MEASURING 1969 SQUARE METRES AS DREPICTED ON SJ Plan No. 4744/6A FOR COMMERCIAL PURPOSES FOR A PERIOD NOT EXCEEDING 9 YEARS AND 11 MONTHS.

MBD 6.1

PREFERENCE POINTS CLAIM FORM IN TERMS OF THE PREFERENTIAL PROCUREMENT POLICY FRAMEWORK ACT

This preference form must form part of all bids invited. It contains general information and serves as a claim form for preference points for Broad-Based Black Economic Empowerment (B-BBEE) Status Level of Contribution

This preference form must form part of all tenders invited. It contains general information and serves as a claim form for preference points for specific goals.

NB: BEFORE COMPLETING THIS FORM, BIDDERS MUST STUDY THE GENERAL CONDITIONS, DEFINITIONS AND DIRECTIVES APPLICABLE IN RESPECT OF THE TENDER AND PREFERENTIAL PROCUREMENT REGULATIONS, 2022

1. GENERAL CONDITIONS

- 1.1 The following preference point systems are applicable to all bids: - the 80/20 system for requirements with a Rand value of up to R50 000 000 (all applicable taxes included);
- 1.2 a) The value of this bid could not be determined, therefore the lowest acceptable tender will be used to determine the applicable preference point system; or
- b) The 80/20 preference point system will be applicable to this tender.
- 1.3 Points for this bid shall be awarded for:
- (a) Price; and
- (b) Preference Goal
- 1.4 The maximum points for this bid are allocated as follows:

	POINTS
RENTAL OFFER	80
PREFERENCE GOALS	20
Total points for Price and Preference goal must not exceed	100

- 1.5 Failure on the part of a bidder to submit proof of CSD report, Consolidated B-BBEE Certificate for Consortium, Joint Venture, Trust or Consortium, Joint Venture, Trust Agreement together with the bid, will be interpreted to mean that preference points for Preference points are not claimed.
- 1.6 The Municipality reserves the right to require of a bidder, either before a bid is adjudicated or at any time subsequently, to substantiate any claim in regard to preferences, in any manner required by the Municipality.

2. DEFINITIONS

- (a) **highest acceptable tender**” means a tender that complies with all specifications and conditions of tender and that has the highest price compared to other tenders;
- (b) **“tender”** means a written offer in the form determined by an organ of state in response to an invitation to provide goods or services through price quotations, competitive tendering process or any other method envisaged in legislation.
- (c) **“price”** means an amount of money tendered for goods or services and includes all applicable taxes less all unconditional discounts.
- (d) **“rand value”** means the total estimated value of a contract in Rand, calculated at the time of bid invitation, and includes all applicable taxes
- (e) **“the Act”** means the Preferential Procurement Policy Framework Act, 2000 (Act No. 5 of 2000).
- (f) **“tender for income-generating contracts”** means a written offer in the form determined by Municipality in response to an invitation for the origination of income-generating contracts through any method envisaged in legislation that will result in a legal agreement between the Municipality and a third party that produces revenue for the Municipality, and includes, but is not limited to, leasing and disposal of assets and concession contracts, excluding direct sales and disposal of assets through public auctions.
- (g) **“specific goals”** means specific goals as contemplated in section 2(1)(d) of the Act which may include contracting with persons, or categories of persons, historically disadvantaged by unfair discrimination on the basis of race, gender and disability including the implementation of programmes of the Reconstruction and Development Programme as published in Government Gazette No. 16085 dated 23 November 1994;

3. DISPOSAL OR LEASING OF STATE ASSETS AND INCOME GENERATING PROCUREMENT

(a)

PRICE POINTS: A maximum of 80 or 90 points is allocated for price on the following basis:

<u>80 / 20 Points System</u>	OR	<u>90 / 10 Points System</u>
$P_s = 80 \left(1 + \frac{P_t - P_{max}}{P_{max}} \right)$		$P_s = 90 \left(1 + \frac{P_t - P_{max}}{P_{max}} \right)$

Where:

P_s = Points scored for price of tender under consideration

P_t = Price of tender under consideration

P_{max} = Price of highest acceptable tender

- (b) A maximum of 10 or 20 points may be awarded to a tenderer for the specific goal specified for the tender.
- (c) The points scored for the specific goal must be added to the points scored for price and the total must be rounded off to the nearest two decimal places.
- (d) Subject to section 2(1)(f) of the Act, the contract must be awarded to the tenderer scoring the highest points.

4. POINTS AWARDED FOR SPECIFIC GOALS

- 4.1 In terms of Regulation 6 and 7 of the Preferential Procurement Regulations 2022 read together with Section 4 (4) and 4 (5) of the Ethekwini Municipality: SCM Policy 2023, preference points must be awarded for specific goals stated in the tender.

For the purposes of this tender the tenderer will be allocated points based on the points claimed for the goal(s) stated in Table 1 & Table 2 below, as supported by proof/ documentation stated in the Conditions of Tender:

- 4.2 In cases where the municipality intends to use Regulation 3(2) of the Regulations, which states that if it is unclear whether the 80/20 or 90/10 preference point system applies, the municipality must, in the tender documents, stipulate in the case of:
- (a) an invitation for tender for income-generating contracts, that either the 80/20 or 90/10 preference point system will apply and that the highest acceptable tender will be used to determine the applicable preference point system:
- 4.3 then the municipality must indicate the points allocated for specific goals for both the 90/10 and 80/20 preference point system.

Specific Goals for the tender and points claimed are indicated as per table 1 and table 2 below. Tenderers are to indicate their points claim for each of the Specific Goals

Ownership Goal

The tendering entity's Percentage Ownership, in terms of the Ownership Category(s) listed below, is to be used in the determination of the tenderer's claim for Preference Points.

Table 1

Goal Weighting 50%			
Ownership Categories	Criteria	80/20	90/10
Race: Black (w1)	0%	0	0
	>0% and <51%	4	2
	≥51% and <100%	7	3.5
	100%	10	5
Proof of claim as declared on MBD 6.1 (1 or more of the following will be used in verifying the tenderer's status) <ul style="list-style-type: none"> • Companies and Intellectual Property Commission registration document (CIPC) • CSD report. • B-BBEE Certificate of the tendering entity. • Consolidated B-BBEE Certificate if the tendering entity is a Consortium, Joint Venture, or Trust (Issued by verification agency accredited by the South African Accreditation System). • Agreement for a Consortium, Joint Venture, or Trust. 			
The Category Weightings of the Ownership Categories will be: w1 = 50%			

RDP Goal: The promotion of South African owned enterprises

The tendering entity's **Address** (as stated on the National Treasury Central Supplier Database (CSD) or on the eThekweni Municipality Vendor Portal) is to be used in the determination of the tenderer's claim for **Preference Points** for this Specific Goal.

Table 2

Goal Weighting 50%		
Location	80/20	90/10
Not in South Africa	0	0
South Africa	4	2
KZN	7	3.5
ETM	10	5
Proof of claim as declared on MBD 6.1 (1 or more of the following will be used in verifying the tenderer's status)		
• CSD report		

- 4.4 All bidders will have to submit BEE rating certificates, issued by either verification agencies accredited by the South African Accreditation System (SANAS) or by registered auditors approved by the Independent Regulatory Board for Auditors (IRBA) or sworn affidavits in a case of Exempted Micro Enterprises or Qualifying Small Enterprise.
- 4.5 Any enterprise with an annual Total Revenue of R 10 million or less qualifies as an Exempted Micro Enterprise.
- 4.6 Exempted Micro-Enterprises are deemed to have B-BBEE Status of "Level Four Contributor" having a BBBEE procurement recognition of 100% in terms of the Codes of Good Practice.
- 4.7 An Exempted Micro Enterprise (EME) with at least 51% black ownership qualifies as a Level 2 contributor with BBBEE level of 125% in terms of the Codes of Good Practice.
- 4.8 An Exempted Micro Enterprise with 100% black ownership qualifies as a Level 1 contributor with BBBEE level of 135% in terms of the Codes of Good Practice.
- 4.9 An Exempted Micro Enterprise that is regarded as a specialized enterprise with at least 75% black beneficiaries qualifies as a Level 1 contributor with BBBEE level of 135% in terms of the Codes of Good Practice.
- 4.10 An Exempted Micro Enterprise that is regarded as a specialized enterprise with at least 51% black beneficiaries qualifies as a Level 2 contributor with BBBEE level of 125% in terms of the Codes of Good Practice.
- 4.11 A Qualifying Small Enterprise (QSE) with at least 51% black ownership qualifies as a Level 2 contributor.
- 4.12 A QSE with 100% black ownership qualifies as a Level 1 contributor.
- 4.13 A QSE that is regarded as a specialized enterprise with at least 51% black beneficiaries qualifies as a Level 2 contributor with BBBEE level of 125% in terms of the Codes of Good Practice.
- 4.14 A QSE with less than 51% black ownership is required to submit a BBBEE level verification certificate issued by BBBEE verification professional.

4.15 A Trust, consortium or joint venture:

- (a) must submit a B-BBEE status level certificate in order to qualify for points;
- (b) will qualify for points as an unincorporated entity provided, that they submit their consolidated scorecard is prepared for separate tender; and
- (c) where no consolidated scorecard exists, the weighted average (in accordance with participation percentages) will be used and rounded off to the nearest status level.

4.16 If a service is provided by only tertiary institutions, such services must be procured from the tertiary institutions identified by means of bidding process. Tertiary institutions must submit their B-BBEE status in terms of the B-BBEE Codes of Good Practice Specialized Scorecard.

4.17 This tender is subject to an Objective Criteria in terms of Section 2 (1) (f) of the Preferential Procurement Policy Framework Act, 2000 (Act No. 5 of 2000) as follows:

<p>Objective criteria in terms of Paragraph 2(1)(f) of the Preferential Procurement Policy Framework Act 5 of 2000 is to give effect to Section 25 (5) of the Constitution of the Republic of South Africa</p>	<p>In line with Section 25 (5) of the Constitution “The state must take reasonable legislative and other measures, within its available resources, to foster conditions which enable citizens to gain access to land on an equitable basis.”</p> <p>The objective criteria will be applied in the following manner:</p> <ul style="list-style-type: none"> 2) The demographic profile of property ownership or access to property will be assessed using the Municipality’s lease register in relation to the location of the subject property and the level of participation in the sector. Preference will be given to the most underrepresented groups within that property profile. The graph depicted under Annexure A on page 57 represents the current demographic profile of existing leases that would apply to this bid. • Bidders must score a minimum of 70 points for Functionality Evaluation in order to qualify for further evaluation in Price and Preference Goal and the Objective Criteria.
<p>Tender(s) received need to be evaluated in terms of the preference point system first. Once the highest points scorer has been ascertained only then the objective criteria will be applied.</p>	

4.18 Award of where Bidders have Scored Equal Points Overall

1. In the event that two or more bids have scored equal total points, the successful bid will be the one scoring highest points for specific goals.
2. However, when functionality is part of the evaluation process and two or more bids have scored equal points including equal points for special goals, the successful bid will be the one scoring the highest score for functionality.
3. Should two or more bids be equal in all respects; the award will be decided by the drawing of lots.

5. DECLARATION WITH REGARD TO COMPANY/FIRM

5.1. Name of company/ firm:.....

5.2. VAT registration number:.....

5.3. Company registration number:.....

5.4. TYPE OF COMPANY/ FIRM

- Partnership/Joint Venture / Consortium
- One person business/sole propriety
- Close corporation
- Company
- (Pty) Limited
- Non-Profit Company
- State Owned Company

[TICK APPLICABLE BOX]

5.5. DESCRIBE PRINCIPAL BUSINESS ACTIVITIES

.....
.....
.....

5.6. COMPANY CLASSIFICATION

- Manufacturer
- Supplier
- Professional service provider
- Other service providers, e.g. transporter, etc.
- Property Development /Management .

[TICK APPLICABLE BOX]

5.7. MUNICIPAL INFORMATION

Municipality where business is situated:

Registered Account Number:

Stand Number:

5.8. Total number of years the company/firm has been in business :.....

I, the undersigned, who warrants that they are authorised to sign on behalf of the Tenderer, certify that the points claimed, based on the specific goals as specified in the tender, qualifies the tendering entity for the preference(s) shown.

I acknowledge that:

- 1) The information furnished is true and correct.
- 2) The preference points claimed are in accordance with the General Conditions as indicated in paragraph 1 of this form.
- 3) In the event of a contract being awarded as a result of points claimed as shown in paragraphs 1.4 and 4.2, the contractor may be required to furnish documentary proof to the satisfaction of the organ of state that the claims are correct.
- 4) If the specific goals have been claimed or obtained on a fraudulent basis, or any of the conditions of contract have not been fulfilled, the organ of state may, in addition to any other remedy it may have:

- (a) disqualify the person from the tendering process.
- (b) recover costs, losses or damages it has incurred or suffered as a result of that person's conduct.
- (c) cancel the contract and claim any damages which it has suffered as a result of having to make less favourable arrangements due to such cancellation.
- (d) recommend that the tenderer or contractor, its shareholders and directors, or only the shareholders and directors who acted on a fraudulent basis, be restricted from obtaining business from any organ of state for a period not exceeding 10 years, after the *audi alteram partem* (hear the other side) rule has been applied; and
- (e) forward the matter for criminal prosecution, if deemed necessary.

<p>WITNESSES</p> <p>1.....</p> <p>2.....</p>	<p>.....</p> <p>SIGNATURE(S) OF BIDDERS(S)</p>
--	--

CONSTITUTIONAL COURT JUDGEMENT

Pursuant to the Constitutional Court judgement which declared Preferential Procurement Regulation 2017 (Regulations) invalid and no force and effect, this procurement document abides by the court order and any reference made to the said Regulations is hereby revoked and replaced by Preferential Procurement Policy Framework Act of 2000.

MDB 7: BIDDERS INFORMATION

Name of Bidder			
ID /Passport/ Registration Number			
Nature of bidder (tick one)	Natural Person/ Sole Proprietor		
	School/NGO/Trust		
	Company/ CC/ Partnership		
	Joint Venture (JV)		
Postal Address		Tel	
		Cell	
		Email	
		Fax	
BIDDER BANKING DETAILS			
Name of bidder's Banker			
Contact details of banker			

I.....
 ...("The Bidder").

in my capacity as

.....
 hereby submit a proposal in the preceding document. I have read the Proposal Call Document in full and hereby submit the MBDs in accordance with the conditions stated in the document, and further declare under oath that the information contained in the MBDs is to the best of my knowledge true and correct. I further state as follows:

Signed and sworn at _____ on this _____ day of _____
 by the Bidder (s) who has stated that:

- He/she knows and understands the contents hereof and that it is true and correct;
- He/she has no objection to taking the prescribed oath; and
- That he /she regards the prescribed oath as binding on his/her conscience
- That the provisions of the regulations contained in Government Notice R1258 of 21st July 1972 (as amended) have been complied with.

 Bidder (s)

Signed before me

 COMMISSIONER OF OATHS

MBD 8: DECLARATION OF BIDDER'S PAST SUPPLY CHAIN MANAGEMENT PRACTICES

- 1 This Municipal Bidding Document must form part of all bids invited.
- 2 It serves as a declaration to be used by municipalities and municipal entities in ensuring that when goods and services are being procured, all reasonable steps are taken to combat the abuse of the supply chain management system.
- 3 The bid of any bidder may be rejected if that bidder, or any of its directors have:
 - a. abused the municipality's / municipal entity's supply chain management system or committed any improper conduct in relation to such system;
 - b. been convicted for fraud or corruption during the past five years;
 - c. willfully neglected, reneged on or failed to comply with any government, municipal or other public sector contract during the past five years; or
 - d. been listed in the Register for Tender Defaulters in terms of section 29 of the Prevention and Combating of Corrupt Activities Act (No 12 of 2004).
- 4 **In order to give effect to the above, the following questionnaire must be completed and submitted with the bid.**

Item	Question	Yes	No
4.1	<p>Is the bidder or any of its directors listed on the National Treasury's Database of Restricted Suppliers as companies or persons prohibited from doing business with the public sector?</p> <p>(Companies or persons who are listed on this Database were informed in writing of this restriction by the Accounting Officer/Authority of the institution that imposed the restriction after the <i>Audi alteram partem</i> rule was applied).</p> <p>The Database of Restricted Suppliers now resides on the National Treasury's website(www.treasury.gov.za) and can be accessed by clicking on its link at the bottom of the home page.</p>	Yes <input type="checkbox"/>	No <input type="checkbox"/>
4.1.1	If so, furnish particulars:		
4.2	<p>Is the bidder or any of its directors listed on the Register for Tender Defaulters in terms of section 29 of the Prevention and Combating of Corrupt Activities Act (No 12 of 2004)?</p> <p>The Register for Tender Defaulters can be accessed on the National Treasury's website (www.treasury.gov.za) by clicking on its link at the bottom of the home page.</p>	Yes <input type="checkbox"/>	No <input type="checkbox"/>
4.2.1	If so, furnish particulars:		
4.3	<p>Was the bidder or any of its directors convicted by a court of law (including a court of law outside the Republic of South Africa) for fraud or corruption during the past five years?</p>	Yes <input type="checkbox"/>	No <input type="checkbox"/>

4.3.1	If so, furnish particulars:		
Item	Question	Yes	No
4.4	Does the bidder or any of its directors owe any municipal rates and taxes or municipal charges to the municipality / municipal entity, or to any other municipality / municipal entity, that is in arrears for more than three months?	Yes <input type="checkbox"/>	No <input type="checkbox"/>
4.4.1	If so, furnish particulars:		
4.5	Was any contract between the bidder and the municipality / municipal entity or any other organ of state terminated during the past five years on account of failure to perform on or comply with the contract?	Yes <input type="checkbox"/>	No <input type="checkbox"/>
4.7.1	If so, furnish particulars:		

CERTIFICATION

I, THE UNDERSIGNED (FULL NAME)
**CERTIFY THAT THE INFORMATION FURNISHED ON THIS
DECLARATION FORM TRUE AND CORRECT.**

**I ACCEPT THAT, IN ADDITION TO CANCELLATION OF A CONTRACT, ACTION MAY BE
TAKEN AGAINST ME SHOULD THIS DECLARATION PROVE TO BE FALSE.**

.....
Signature

.....
Date

.....
Position

.....
Name of Bidder

MBD 9: CERTIFICATE OF INDEPENDENT BID DETERMINATION

- 1 This Municipal Bidding Document (MBD) must form part of all bids¹ invited.
- 2 Section 4 (1) (b) (iii) of the Competition Act No. 89 of 1998, as amended, prohibits an agreement between, or concerted practice by, firms, or a decision by an association of firms, if it is between parties in a horizontal relationship and if it involves collusive bidding (or bid rigging).² Collusive bidding is a *pe se* prohibition meaning that it cannot be justified under any grounds.
- 3 Municipal Supply Regulation 38 (1) prescribes that a supply chain management policy must provide measures for the combating of abuse of the supply chain management system, and must enable the accounting officer, among others, to:
 - a. take all reasonable steps to prevent such abuse;
 - b. reject the bid of any bidder if that bidder or any of its directors has abused the supply chain management system of the municipality or municipal entity or has committed any improper conduct in relation to such system; and
 - c. cancel a contract awarded to a person if the person committed any corrupt or fraudulent act during the bidding process or the execution of the contract.
- 4 This MBD serves as a certificate of declaration that would be used by institutions to ensure that, when bids are considered, reasonable steps are taken to prevent any form of bid-rigging.
- 5 In order to give effect to the above, the attached Certificate of Bid Determination (MBD 9) must be completed and submitted with the bid:

¹ Includes price quotations, advertised competitive bids, limited bids and proposals.

² Bid rigging (or collusive bidding) occurs when businesses, that would otherwise be expected to compete, secretly conspire to raise prices or lower the quality of goods and / or services for purchasers who wish to acquire goods and / or services through a bidding process. Bid rigging is, therefore, an agreement between competitors not to compete.

MBD 9: CERTIFICATE OF INDEPENDENT BID DETERMINATION

I, the undersigned, in submitting the accompanying bid:

(Bid Number and Description)

in response to the invitation for the bid made by:

(Name of Municipality / Municipal Entity)

do hereby make the following statements that I certify to be true and complete in every respect:

I certify, on behalf of: _____ that:

(Name of Bidder)

1. I have read and I understand the contents of this Certificate;
2. I understand that the accompanying bid will be disqualified if this Certificate is found not to be true and complete in every respect;
3. I am authorized by the bidder to sign this Certificate, and to submit the accompanying bid, on behalf of the bidder;
4. Each person whose signature appears on the accompanying bid has been authorized by the bidder to determine the terms of, and to sign, the bid, on behalf of the bidder;
5. For the purposes of this Certificate and the accompanying bid, I understand that the word "competitor" shall include any individual or organization, other than the bidder, whether or not affiliated with the bidder, who:
 - (a) has been requested to submit a bid in response to this bid invitation;
 - (b) could potentially submit a bid in response to this bid invitation, based on their qualifications, abilities or experience; and
 - (c) provides the same goods and services as the bidder and/or is in the same line of business as the bidder
6. The bidder has arrived at the accompanying bid independently from, and without consultation, communication, agreement or arrangement with any competitor. However communication between partners in a joint venture or consortium³ will not be construed as collusive bidding.

7. In particular, without limiting the generality of paragraphs 6 above, there has been no consultation, communication, agreement or arrangement with any competitor regarding:
- (a) prices;
 - (b) geographical area where product or service will be rendered (market allocation)
 - (c) methods, factors or formulas used to calculate prices;
 - (d) the intention or decision to submit or not to submit, a bid;
 - (e) the submission of a bid which does not meet the specifications and conditions of the bid; or
 - (f) bidding with the intention not to win the bid.
8. In addition, there have been no consultations, communications, agreements or arrangements with any competitor regarding the quality, quantity, specifications and conditions or delivery particulars of the products or services to which this bid invitation relates.
9. The terms of the accompanying bid have not been, and will not be, disclosed by the bidder, directly or indirectly, to any competitor, prior to the date and time of the official bid opening or of the awarding of the contract.

³ Joint venture or Consortium means an association of persons for the purpose of combining their expertise, property, capital, efforts, skill and knowledge in an activity for the execution of a contract.

10. I am aware that, in addition and without prejudice to any other remedy provided to combat any restrictive practices related to bids and contracts, bids that are suspicious will be reported to the Competition Commission for investigation and possible imposition of administrative penalties in terms of section 59 of the Competition Act No 89 of 1998 and or may be reported to the National Prosecuting Authority (NPA) for criminal investigation and or may be restricted from conducting business with the public sector for a period not exceeding ten (10) years in terms of the Prevention and Combating of Corrupt Activities Act No 12 of 2004 or any other applicable legislation.

.....
Signature	Date
.....
Position	Name of Bidder

MBD 10: STANDARD CONDITIONS OF SUBMISSION

The following conditions apply to all bids submitted:

- All bids must be submitted in compliance with the Bid Specifications specified in MBD 12.
- The property is made available in accordance with the information and stipulations contained in REU MBD 13.
- The bidder(s) will be deemed to be familiar with the state, real rights registered against the property, the zoning and locality of the property.

SELECTION CRITERIA

Failure to meet the following requirements will invalidate the bid:

- Failure to meet mandatory requirement;
- Any rental offer below the reserve price;
- Bids that deviate from the tender specification;
- Any proposal that does not include redevelopment of the land or the proposed usage is not in line with the zoning of the property;
- Non-commissioning of MBD 7 and non-signature of the Municipal Bidding Documents (MBD's).
- Any development proposal that is outside the scope of this tender;

NB: Failure to comply with the above will result in the bid not being evaluated.

CONDITIONS OF SUBMISSION FOR REQUEST FOR PROPOSAL

- Tax Clearance Certificate, valid on the closing date of the bid, or exemption to pay taxes as issued by the South African Revenue Services (SARS) or Valid Tax Compliant Verification PIN number issued by SARS.
- Proof of registration of the Entity as follows:
 - Natural persons- certified copy of ID document/ passport
 - Partnership- copy of Partnership Agreement plus IDs of all partners
 - Company- current CM29/COR 20.1
 - Close Corporation- current copy of CK1 and/or CK2C and/or COR 20.1
 - Trust- letter of appointment from the Master of the High Court of SA and deed of trust o JV/Consortium- JV/Consortium Agreement plus CIPC and/or ID documents of all JV/Consortium partners
 - Entity valid BBBEE Certificate issued by agency accredited by SANAS /Valid Sworn affidavit or valid BBBEE certificate JV/Consortium issued by agency accredited by SANAS or BBBEE Certificate from CIPC.
- Up to date Municipal Account not older than three (3) months and not over three (3) months in arrears for the individual / Proof that acknowledgements or arrangements have been made to settle arrears / Affidavit stating why an up-to-date municipal account cannot be submitted / valid lease agreement.
- Up to date Municipal Account not older than three (3) months and not over three (3) months in arrears for the Entity / Proof that acknowledgements or arrangements have been made to settle arrears / Affidavit stating why an up-to-date municipal account cannot be submitted / valid lease agreement.
- Up to date Municipal Account not older than three (3) months and not over three (3) months

in arrears for the Director (s) or Member (s) / Proof that acknowledgements or arrangements have been made to settle arrears / Affidavit stating why an up-to-date municipal account cannot be submitted / valid lease agreement.

- In the event the bidder is tendering as a Joint Venture/Consortium, all members of the
- JV/Consortium must submit all required documentation, a JV / Consortium agreement and a BBBEE certificate.
- Central Supplier Database (CSD) registration valid on tender closing date.
- Company resolution for bid signing powers.
- Completed and signed bid documents including MBD 1 to MBD 22.
- If the entity or any of its directors are listed on the National Treasury register of defaulters, the bid will be rejected.

SUBMISSION OF PROPOSALS

- Bidder(s) are invited to submit their Proposals by completing the returnable Municipal Bidding Documents (MBDs) and MBDs contained in this document.
- In this regard:
 - No other form of Proposal will be accepted. The MBDs must not be construed as an offer.
 - The Bidder(s) must submit one (1) original hard copy, one (1) copy plus scanned version of the submission including all annexures/ returnables in a USB clearly marked in bidder's name.
 - All Proposal documentation received shall be deemed Ethekewini Municipality property and shall not be returned or thus requested back by any Bidder.
- Proposals must be sealed, clearly marked with RFP name and number, and addressed to Head: Real Estate
- Bidder's return address must be clearly indicated at the back of the envelope.
- The fully completed document with annexures must be submitted before the closing date specified on the front cover and be deposited in the tender box.

SUBMISSION OF PROPOSALS

- Bidder(s) are invited to submit their Proposals by completing the returnable Municipal Bidding Documents (MBDs) and MBDs contained in this document.
- In this regard:
 - No other form of Proposal will be accepted. The MBDs must not be construed as an offer.
 - No other form of Proposal will be accepted. The MBDs must not be construed as an offer.
 - The Bidder(s) must submit one (1) original and three (3) copies of the of the completed Bid document.
 - All Proposal documentation received shall be deemed EThekewini Municipality property and shall not be returned or thus requested back by any Bidder.

- Proposals must be sealed, clearly marked with RFP name and number, and addressed to Head: Real Estate
- Bidder's return address must be clearly indicated at the back of the envelope.
- The fully completed document with annexures must be submitted before the closing date specified on the front cover and be deposited in the tender box.
- **PROPOSALS WHICH ARE NOT SUBMITTED IN A PROPERLY SEALED AND MARKED ENVELOPE AND DEPOSITED IN THE BOX BEFORE THE CLOSING DATE, WILL NOT BE OPENED.**
- **PROPOSALS WHICH ARE NOT SUBMITTED IN THE CORRECT FORMAT WITH ANNEXURES ATTACHED, DULY COMPLETED, INITIALLED, COMMISSIONED AND SIGNED, WILL NOT BE CONSIDERED.**
- The information required in the MBDs must be provided accurately and honestly. All details provided by the Bidder(s) will be regarded as material representations, which the Municipality base the evaluation of the Proposal on. Any misrepresentation will be treated as material and will result in the disqualification of the Proposal by the Municipality. Bidders, who fail to provide such information to the satisfaction of the Municipality, will be disqualified.

OPENING OF PROPOSALS

- Proposals will be opened immediately after the closing time on the closing date at the offices of the Municipality at the mentioned address. The RFP number, property description and the name of each Bidder(s) will be announced and recorded in a register.
- Bidder's return address must be clearly stipulated or indicated on the back of the envelope.

EVALUATION OF PROPOSALS

- The Municipality reserves the right to seek clarification or further information from Bidder(s) and to appoint professionals to advise and verify information on aspects of the Proposals submitted in a manner that the Municipality deems appropriate.
- The preferred Bidder(s) may be required to make presentations to the Municipality.
- The Bidder(s) shall be deemed to know and understand the content of the Request for Proposal document and a submission of the MBDs will indicate the Bidder(s) unconditional acceptance of all the terms and conditions contained in the Request for Proposal.
- The Bidder(s) shall be deemed to have satisfied itself as to all of the conditions, procedures and performance and discharge of the obligations required in terms of the Request for Proposal.
- The non-acceptance or variation of any of the conditions, or the inclusion of any other conditions in the Proposal Call document by the Bidder(s) will be treated as a qualified bid.
- The Proposal(s) will be evaluated by the Municipality. The Municipality may accept any Proposal in whole or in part and is not bound to accept any Proposal
- Proposals will be evaluated using the evaluation criteria stated in MBD 11.
- The Proposal(s) will be adjudicated by the Municipality's Bid Adjudication Committee and awarded in terms of the City's Supply Chain Management Policy and the Land Disposal

Policy.

- The Municipality will not be held responsible or liable for any costs whatsoever and /or losses incurred or suffered by the Bidder(s) or any other party or parties for whatsoever reason as a result of the Proposal.
- Any Proposal in the name of a partnership or joint venture or consortium will, on acceptance, be deemed as joint and several agreements with all parties.
- All proposals shall remain valid for a period of 120 days after the closing date, provided that bidders may extend the validity of the proposal on request of the Municipality.

RESOLUTIONS OF DISPUTES

- Persons or bidders who are aggrieved by decisions or actions taken in the implementation In terms of Regulation 49 of the Municipal Supply Chain Management Regulations persons aggrieved by decisions or actions taken by the Municipality, may lodge an appeal within 14 days of the decision or action, in writing to the Municipality. The appeal (clearly setting out the reasons for the appeal) and queries with regard to decision of award are to be directed to the office of the City Manager, attention: Ms. S. Pillay, P.O. Box 1394, Durban, 4000; eMail: Simone.Pillay@durban.gov.za.
- The written complaint must contain the following information:
 - The bid reference number;
 - The section of the Policy, Regulations or Act that has been violated;
 - The details of the violation;
 - The City Department or Municipal Owned Entity involved;
 - Relief sought.

PROHIBITIONS

- The Municipality will not, subject to such amendments to the Act and Regulations and any exemptions as the Minister may promulgate from time to time, award contracts to Bidder(s) who are owned directly or indirectly by the following categories of persons: -
- Defined as an employee or public servant in the service of the state working for Local, Provincial and National Government; or
- Defined as an employee in the service of a government owned entity including the municipal entities;
- If the employee mentioned above is actively or inactively a director, manager or principal shareholder of the service provider concerned (refer to GN44 in GG 28411 of 18 January 2006 for the exemption);
- Is a member of the board of directors of a municipal entity within its area of jurisdiction (refer to GN44 in GG 28411 of 18 January 2006 for the exemption);
- Who is an advisor or consultant contracted to the Municipality for the purposes of assisting the Municipality with defining of requirements, drafting of specifications or evaluation of the Proposals.
- The Municipality will not award Proposals to any Bidder(s) owned directly or indirectly by politicians serving as councillors for any municipality.

- The Municipality will not award Proposals to any Bidder(s) owned directly or indirectly by politicians serving in National Assembly, Provincial Legislatures and National Council of Provinces.
- Failure by the above-mentioned persons to comply with the above shall lead to cancellation of the contract.

CONSIDERATION OF PROPOSALS FROM CLOSE FAMILY MEMBERS OF PERSONS IN THE SERVICE OF THE STATE

- The Municipality does not encourage awarding of contracts to close family members of employees in decision-making positions in line with Regulation 45 of the Supply Chain Management Regulations.
- The bidder must declare and state whether a spouse, child or parent of the bidder or of a director, manager or shareholder is in the service of the Ethekewini Municipality or has been in the service of the state in the previous twelve months.

GENERAL ENQUIRIES

Only email enquiries will be accepted, such enquiries must be directed to Alan.Tromp@durban.gov.za.

REU MBD 11: EVALUATION CRITERIA

Bids which satisfy the qualification criteria will be evaluated using a two-stage evaluation process as follows:

Stage 1: Functionality Evaluation

Bids will be evaluated in order to establish whether they meet a minimum threshold score of 70 points out of 100 for functionality, based on the following criteria:

FUNCTIONAL CRITERIA	Max Points	Returnable documents to be used in evaluation
PROPOSED CONCEPT	30	
<p>Conformity of the Development Proposal to the vision for the property as expressed in REU MBD 12.</p> <p>Development Concept - High level conceptual design outlining the intended uses = 15 Points</p> <p>The proposed site layout, extent of buildings in square metres, height, elevations and floor plans= 5 Points</p> <p>Ratios of the different land uses proposed inclusive of Floor plans and elevations= 5 Points</p> <p>Architectural aesthetic of the proposed development= 5 Points</p> <p>No submission = 0 Points</p>	15	<p>Bidder to submit A3 size drawings and diagrams which specify the following:</p> <ul style="list-style-type: none"> • Ratios of the different proposed land uses • Indicative building footprints/ massing form, paying attention to edges and interfaces • Plans that are compatible to the character of the existing built environment and provide enhancements that improve the nature of the. • Architectural aesthetic of the proposed development
<p>Development Programme</p> <p>High level development programme including Inception Stage, Planning, Design, Construction and Commissioning.</p> <p>A high level plan indicating 5 stages and each timeframe for each stage = 15 Points</p> <p>A high level plan indicating 4 of the 5 stages and each timeframe for each stage = 12 Points</p> <p>A high level plan indicating 3 of the 5 stages and each timeframe for each stage = 10 Points</p> <p>A high level plan indicating 2 of the 5 stages and each timeframe for each stage = 7 Points</p> <p>A high level plan indicating 1 of the 5 stages and each timeframe for each stage = 2 Point</p> <p>A high level plan indicating 0 of the 5 stages and each with no timeframe for each stage or no submission = 0 Points</p>	15	<p>Narrative – High level redevelopment/ refurbishment programme including Inception Stage, Planning, Design, Construction and Commissioning and including timeframes for each stage.</p>
CAPACITY AND EXPERIENCE	24	
<p>Professional Team (12).</p> <p>Must have 3 years post registration experience, provide CVs and Proof of Registration documents and a maximum of 2 traceable references of work that is ≥ R3 million for each project. This amount refers to consultants' fee portion of the project value.</p>	12	<p>REU MBD 21</p> <p>CV's of the professional team and proof of registration with professional bodies where requested, a maximum of 2 traceable references of work that is ≥ R3 million for each project. This</p>

		amount refers to consultants' fee portion of the project value.
<p>Architect with 3 years post registration experience, (registration with relevant institutions/statutory bodies and 2 traceable references = (3 Points)</p> <p>Proof of professional registration = 1 Point Proof of 3 years post registration experience = 1 Point Proof of 2 traceable references of work that is ≥ R3 million for each project = 1 Point</p> <p>NB: No points will be allocated to the Architect without proof of registration, less than 3 years post registration and has less than 2 traceable references of work that is ≥R1 million for each project.</p>	3	<p>REU MBD 21</p> <p>CV's of the professional team and proof of registration with professional bodies where requested, a maximum of 2 traceable references of work that is ≥ R1 million for each project. This amount refers to consultants' fee portion of the project value.</p>
<p>Quantity Surveyor (registration with relevant institutions/statutory bodies and traceable references) = 3 Points</p> <p>Proof of professional registration = 1 Point Proof of 3 years post registration experience = 1 Point Proof of 2 traceable references of work that is ≥ R3 million for each project = 1 Point</p> <p>NB: No points will be allocated to the Pr QS without proof of registration, less than 3 years post registration and has less than 2 traceable references of work that is ≥R3 million for each project.</p>	3	REU MBD 21
<p>Engineers (civil and electrical) (registration with relevant institutions/statutory bodies and traceable references) = 3 Points</p> <p>Proof of professional registration = 1 Point Proof of 3 years post registration experience = 1 Point Proof of 2 traceable references of work that is ≥ R3 million for each project = 1 Point</p> <p>NB: No points will be allocated to the Engineer without proof of registration, less than 3 years post registration and has less than 2 traceable references of work that is ≥R3 million for each project.</p>	3	REU MBD 21
<p>Project Manager (registration with relevant institutions/statutory bodies and traceable references) = 3 Points</p> <p>Proof of professional registration = 1 Point Proof of 3 years post registration experience = 1 Point Proof of 2 traceable references of work that is ≥ R3 million for each project = 1 Point</p> <p>NB: No points will be allocated to the PM without proof of registration, less than 3 years post registration and has less than 2 traceable references of work that is ≥R3 million for each project .</p>	3	REU MBD 21
<p>Construction Team Bidder to submit, profiles, experienced and qualifications (with a minimum of 3 years' experience)</p>	12	Bidders to complete REU MBD 21 and provide any verifiable documents to demonstrate its experience.

<p>Site Manager = 3 points</p> <p>Proof that the Site Manager has in excess of 3 years' relevant work experience= 1 Points</p> <p>Proof of the Site Manager has completed 2 projects in the last 5 years = 2 Points</p> <p>NB: No points will be allocated to Site manager with less than 3 years of experience and have not completed 2 projects in the last 5 years.</p>	3	Bidders to complete REU MBD 21 and provide any verifiable documents to demonstrate its experience. REU MBD 21
<p>Registered Health & Safety Officer = 3 points</p> <p>Proof of professional registration as health and Safety officer = 1 Point</p> <p>Proof that the Health & Safety Officer has in excess of 3 years' relevant work experience= 1 Points</p> <p>Proof of the Health & Safety Officer has completed 2 projects in the last 5 years = 1 Points</p> <p>NB: No points will be allocated to Registered Health & Safety Officer with less than 3 years of experience and have not completed 2 projects in the last 5 years.</p>	3	
<p>Social Facilitator = 3 points</p> <p>Proof that the Social Facilitator has in excess of 3 years' relevant work experience= 1 Points</p> <p>Proof of the Social Facilitator has completed 2 projects in the last 5 years = 2 Points</p> <p>NB: No points will be allocated to the Social Facilitator with less than 3 years of experience and has less than 2 traceable references of work that is for each project.</p>	3	REU MBD 21
<p>Main contractor- Evidence of at least 3 or more Completed Projects of a similar nature (i.e. Development/ Building Conversion/Refurbishment) = 3 points</p> <p>Proof of 3 more similar projects= 3 Points Proof of 2 similar project = 2 Points Proof of 1 similar project= 1 Points</p> <p>0 points will be awarded for contractors who have completed 0 project of a similar nature.</p>	3	REU MBD 21
TRANSFORMATION AND EMPOWERMENT PLAN	26	
<p>a Job Creation Plan including the plan During Construction = 4 points After Construction = 7 points</p> <p>Enterprise Development (during and after construction) = 3 points</p> <p>Training and Development Programmes (throughout the lifecycle of the project) = 3 points</p> <p>Demonstrate how the development will benefit the local community and/or community-based organisations = 3</p>	26	Local Employment Plan including training and skills development. The bidder is expected to provide a detailed plan outlining how it would empower SMME's and individuals through the fitment of the facility to make it operational. MBD 20

points		
Procurement of Material from Local Suppliers = 3 points		
Partnership with Women, Youth, and People with disabilities owned Companies= 3 points		
FINANCIAL CAPABILITY	20	
a) Investment Value	10	REU MBD 22
The reserved price indicated on the offer page should be used as a benchmark for the market value of the property		
Total realistic monetary investment value into the project based on the similar projects backed by the QS report/ estimated development cost and a financial feasibility. = 10 Points		
Total investment not specified = 0 Points		
Funding Model	10	REU MBD 22
Provide funding model to incorporate how and where the funding will be sourced/raised and it must include collateral to be pledged against such funding if required.		Copy of bank statements showing availability of funds.
The bidder to demonstrate proof of availability of 100% of the funding required for the development/ refurbishment. This must include written support from verifiable funding institutions.		Financial Statements
•If the letter from the registered funder reflects the full amount of the development cost or;		Letter from registered funding institutions confirming funding for the project
•If there is a shortfall and the bidder shows how they fund the shortfall or		Proof of available funds (bank statements or financial statements of the bidder
•If the funder demonstrate access to equity to cover the development cost or;		
•If the AFS reflect cash and cash equivalents or;		
Letter from registered funding institutions confirming funding for the project Proof of available funds (bank statements or financial statements of the bidder. = 10 Points		
Non-Submission of a Letter from registered funding institutions confirming funding for the project or proof of available funds (bank statements or financial statements of the bidder = 0 Points		
Total	100	

Bids which do not meet the minimum threshold of 70 points will not be considered further.

STAGE 2: EVALUATION FINANCIAL OFFER & PREFERENCE POINT SYSTEM

- Tender(s) received need to be evaluated in terms of the preference point system first. Once the highest points scorer has been ascertained only then the objective criteria will be applied.
- Preference points shall be calculated after financial offers have been brought to a comparative basis.
- Points scored will be rounded off to 2 decimal places.
- In the event of equal points scored, the bid will be awarded to the bidder scoring the highest number of points for specified goals.
- A maximum of 80 points is allocated for financial offer on the following basis:

$$PS = 80 \left(1 + \frac{Pt - P_{max}}{P_{max}} \right)$$

Where

- Ps = Points scored for price of tender bid under consideration
- Pt = Rand value of bid under consideration (Net Present Value of the rental amount over the lease period discounted at 10%)
- Pmax = Financial Offer of highest acceptable bid

√ **Only those bids that attain the minimum threshold score of 70 Points in Stage 1 (functionality) will be evaluated in this stage. Bids will be evaluated as follows:**

EVALUATION CRITERIA	POINTS WEIGHT 80/20
RENTAL OFFER	80
PREFERENCE GOALS	20
Total	100

REU MBD 12: BID SPECIFICATIONS

The following Specifications apply to this bid:

1. Property Information

PROPERTY DESCRIPTION	Erf 2586 Mobeni
Ownership	eThekwini Metropolitan Municipality
Locality	Mobeni
Land Size	1960 m ²
Zoning	General Industrial Vacant land
Current Use	
FAR	n/a
Coverage	As per Scheme
Height	As per scheme
Access	Warrington road-Leicester road
Building lines	As per scheme
Heritage	n/a
Structural and Physical feature	Vacant land
Geotechnical Conditional	Any geotechnical conditions will be the responsibility of the Developer.
Other Requirements	<p>A Site Development Plan shall be submitted to the Local Authority Any further town planning Proposals and or rezoning shall be the responsibility of the Developer.</p> <p>The bidder is required to comply will all relevant building regulation laws, including but not limited to SPLUMA, NEMA, Municipal Bylaws etc.</p> <p>The site shall be used for commercial purposes and shall be suitable fenced and no advertising shall be allowed on the fence.</p> <p>No encroachment over municipal sewer servitude /sewer line shall be permitted.</p>

2. Overview

Erf 2586 Mobeni at Warrington Road-Leicester Road, Springfield, in extent 1960m² the property is owned by the eThekwini Municipality. The property has a General industrial zoning and can be developed on its own and currently vacant.

Mobeni form part of the greater South Industrial Basin region. Mobeni West is situated west of South Coast Road and is primarily occupied by large-scale industrial premises geared towards manufacturing. Mobeni East forms part of the township of Dunns Grant. The Mobeni East and Jacobs Industrial node is bisected by the Inkosi Albert Luthuli Freeway (M4) and is in an area south of the Harbour and north of the Durban Airport. This area has experienced increased demand and with the recent completion of the upgrading of the Quality Street intersection with the M4, this trend should remain.

This node is approximately 13 kilometres south of the Durban Central Business District. A large labour pool exists in Umlazi, west of subject node. The Old Durban International Airport is located 2 kilometres south and is accessed from the N2.

Developments found here are typically of an industrial and a manufacturing nature but also include some offices. This node is characterised by established and emerging tenants and/or owner-occupiers. Surrounding residential areas include Wentworth, Merewent, Montclair and the Bluff to the north. It enjoys good access as well as being in close proximity to the Harbour. Public facilities, amenities and public transport are provided on South Coast Road. Surrounding areas comprise 'low-income' residential accommodation and similar 'port related' industrial properties.

3. Vision for the property

The proposals should align the facility to the City's vision for the area in line with the strategies, legislative requirements and regulatory frameworks.

CONDITIONS OF DEVELOPMENT LEASE.

The property is made available in accordance with the site information made available in MBD13.

Property Tenure

The Property shall be made available by means of a long-term lease agreement in accordance with eThekweni Municipality's standard agreement. The following terms of contract are non-negotiable:

1. The lease period will be up to a period of 9 years and 11 months. Upon expiry or termination of the Development and Lease agreement, possession of the property will revert to the eThekweni Municipality without any compensation. :-
2. Bidders are required to make an offer not less than the minimum acceptable offer for the lease of the facility on the property as part of the proposal form; as indicated in REU MBD 12.
3. The rental is reviewable every five (5) years and cannot be lower than the value at the time of award. The escalation is also reviewable every five (5) years.
4. The lessee shall under no circumstances cede any rights of the property to a third party without consent from the Municipality;
5. The successful bidder will be responsible for the cancellation, protection and/or relocation of all servitudes that may be registered over the property.
6. Bidders are required to demonstrate their ability and capacity to deliver and manage the proposed development.
7. Any change in the shareholding should not result in a decrease in the levels of the demographics that were recorded at the time of tender. A change in control of the lessee without the written consent of the Lessor shall be deemed to be a breach of the lease.
8. Bidders are required to demonstrate their ability and capacity to deliver and manage the proposed development by submitting a detailed profile of the professional team and their successfully completed development. They must further demonstrate their ability to secure funds required to carry out the project.
9. Bidders are to submit an annual break down of the maintenance plan for the duration of the lease.
10. The premises shall only be utilised for the purpose as advertised and may not be rezoned for any other purposes for the duration of the lease period;
11. That, a deposit equal to three month's rental shall be paid by the lessee upon signature of the lease agreement. Such deposit shall be refundable if all rental amounts are paid up date at the time of the expiry of the lease agreement or vacation of property, subject to the property being returned in a clean and tidy condition.
12. All administrative and incidental costs relating to the drafting of the lease shall be for the lessee's account.

13. Bidders are to submit an annual break down of the maintenance plan for the duration of the lease.
14. Bidders are required to submit a financial proposal which is not limited to but should include;
 - o A detailed cost estimate, together with supporting documentation of the costs of development.
 - o A time schedule for the development of the building.
15. That, the application shall be liable for the payment of all sewerage, refuse removal fees, Levied or payable in respect of the site and all electricity and water supplied to the site.
16. That all environmental and related legislation and By-laws applicable to the Property shall be complied with and that all building plans to be submitted to the Local Authority for approval prior to any construction.
17. That, all Emergency Management Services By-laws be complied with and adhered to and that access to emergency vehicles should be provided on the property.
18. The Council and its authorised representatives/agents shall have 24 hours' unrestricted access to the electricity, water and any Municipal Servitudes on the property and that no structures will be allowed within these servitudes.
19. The bidder is expected to submit a detailed empowerment plan demonstrating how the following will be achieved:
 - a. Job Creation Plan (during and after redevelopment)
 - b. Enterprise Development (during and after construction)
 - c. Training and Development Programmes (throughout the lifecycle of the project)
 - d. Demonstrate how the development will benefit the local community and/or community based organisations
 - e. Procurement of Material from Local Suppliers
 - f. Partnership with Women Owned Companies

Bidders are expected to advice and provide a detailed plan and how the numbers are achieved

REU MBD 13: PROPERTY INFORMATION

1. SITE INFORMATION

Property Description	ERF 2586 Mobeni
Size (Lease area)	1969m ²
Zoning	GENERAL INDUSTRIAL
Structures and Physical features	VACANT LAND
Current Use	Vacant land
Minimum Acceptable Rental Offer	R29 400.00 per month
Highest and Best Use	The highest and best use is considered to be for commercial purposes.
Services	

2. Aerial Photo

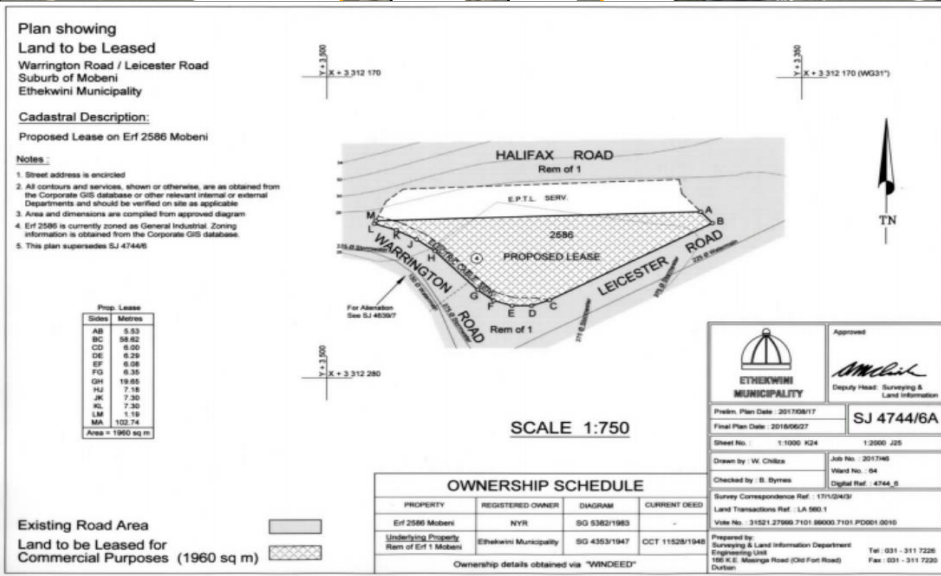

ZONE: GENERAL INDUSTRY						
<p>SCHEME INTENTION: To provide, preserve, use land or buildings for:</p> <ul style="list-style-type: none"> • Full range of industrial uses where the emphasis is on bulk and heavy industry and where due cognizance must be taken of environmental impacts. • Ensuring sustainable locations for uses which accommodate the requirements for industrial activities and minimize their impact on surrounding uses. 						
<p>MAP COLOUR REFERENCE: Purple with Dark Purple horizontal Lines</p>			<p>MAP REFERENCE:</p>			
PRIMARY		SPECIAL CONSENT			PRECLUDED	
<ul style="list-style-type: none"> • Arts and Crafts Workshop • Builder's Yard • Car Wash • Display Area • *Dwelling House • Government / Municipal • Industry – General • Laundry • Industry – Light • Motor Display Area • Motor Garage • Motor Vehicle Test Centre • Motor Workshop • Recycling Centre • Refuse Disposal • Direct Access Service Centre • Fuelling and Service Station • Funeral Parlour • Scrap Yard • Transport Depot • Truck Stop • Utilities Facility • Warehouse 		<ul style="list-style-type: none"> • Action Sports Bar • Adult Premises • Base Telecommunications Transmission Station • Betting Depot • Cemetery/Crematorium • Educational Establishment • Garden Nursery • Institution • Mortuary • Night Club • Health Studio • Agricultural Activity • *Office • *Office – Medical • Parkade • Pet Grooming Parlour • Place of Public Entertainment • Place of Public of Worship • *Shop • *Restaurant / Fast Food Outlet • Special Building • Veterinary Clinic • Museum • Any other use authorised in terms of Section 9.4 			<ul style="list-style-type: none"> • All other uses not indicated in the Primary and Special Consent columns 	
ADDITIONAL CONTROLS						
<p>1. *A Dwelling House may be permitted to accommodate a manager, foreman, caretaker or security personnel. 2. *Offices and *Office-Medical used in conjunction with an industrial use shall be freely permitted. 3. In respect of Portion 1 of Erf 7057 Durban, situated at 56 Calais Road, Congella, a student accommodation use may be permitted with the special consent of the Municipality.</p>						
SPACE ABOUT BUILDINGS		DWELLING UNITS PER HECTARE	MINIMUM SUBDIVISION	HEIGHT	COVERAGE	FLOOR AREA RATIO
BUILDING LINE	SIDE AND REAR SPACE					
Nil	Nil	N/A	900	25M	N/A	N/A

MBD 14: REGISTRATION DOCUMENTS

The following documents must be submitted at the time of tender closing

- Natural persons, Sole proprietors and JVs – copy of ID document/passport
- Schools – copy of Provincial School registration certificate
- NGO – copy of Provincial registration certificate
- Society Club/ Association – copy of Constitution / founding document
- Partnership -copy of partnership agreement plus IDs of all partners
- Closed Corporation - Copy of CK1 and/or CK2 and members' agreement
- Company – current CM29,
- Trust – letter of appointment from the Master of the High Court of SA and deed of trust
- Joint Venture / Consortiums– JV agreement plus ID documents/ company Registration document of all members of JV/ Consortiums.

MBD 15: AUTHORITY TO SUBMIT BID

If bidder is a legal entity, a company resolution /Power of Attorney must be attached (these documents must authorise the named person to submit this application and to enter into agreements with the eThekweni Municipality should the application be successful)

Is a company resolution attached?	Yes	<input type="checkbox"/>	No	<input type="checkbox"/>
-----------------------------------	-----	--------------------------	----	--------------------------

Is the bidder a natural person?	<input type="checkbox"/>	<input type="checkbox"/>	<input type="checkbox"/>	<input type="checkbox"/>
Is a certified ID copy attached?	Yes	<input type="checkbox"/>	No	<input type="checkbox"/>

Is a copy of the bidder's power of attorney attached?	Yes	<input type="checkbox"/>	No	<input type="checkbox"/>
---	-----	--------------------------	----	--------------------------

MBD 16: DECLARATION OF MUNICIPAL FEES

I, the undersigned, do hereby declare that the Municipal fees of

.....
(full name of Company / Close Corporation / partnership / sole proprietary/Joint Venture)

(hereinafter referred to as the TENDERER) are, as at the date hereunder, fully paid or an Acknowledgement of Debt has been concluded with the Municipality to pay the said charges in instalments.

The following account details relate to property of the said TENDERER:

<u>Account</u>	<u>Account Number:</u> to be completed by tenderer.
Consolidated Account No.	<input type="text"/> <input type="text"/> <input type="text"/> <input type="text"/> <input type="text"/> <input type="text"/> <input type="text"/> <input type="text"/> <input type="text"/> <input type="text"/> <input type="text"/> <input type="text"/> <input type="text"/> <input type="text"/> <input type="text"/> <input type="text"/>
Electricity	<input type="text"/> <input type="text"/> <input type="text"/> <input type="text"/> <input type="text"/> <input type="text"/> <input type="text"/> <input type="text"/> <input type="text"/> <input type="text"/> <input type="text"/> <input type="text"/> <input type="text"/> <input type="text"/> <input type="text"/>
Water	<input type="text"/> <input type="text"/> <input type="text"/> <input type="text"/> <input type="text"/> <input type="text"/> <input type="text"/> <input type="text"/> <input type="text"/> <input type="text"/> <input type="text"/> <input type="text"/> <input type="text"/> <input type="text"/> <input type="text"/>
Rates	<input type="text"/> <input type="text"/> <input type="text"/> <input type="text"/> <input type="text"/> <input type="text"/> <input type="text"/> <input type="text"/> <input type="text"/> <input type="text"/> <input type="text"/> <input type="text"/> <input type="text"/> <input type="text"/> <input type="text"/>
Other	<input type="text"/> <input type="text"/> <input type="text"/> <input type="text"/> <input type="text"/> <input type="text"/> <input type="text"/> <input type="text"/> <input type="text"/> <input type="text"/> <input type="text"/> <input type="text"/> <input type="text"/> <input type="text"/> <input type="text"/>

I acknowledge that should the aforesaid Municipal charges fall into arrears, the Municipality may take such remedial action as is required, including termination of any contract, and any payments due to the Contractor by the Municipality shall be first set off against such arrears.

- Where the TENDERER'S place of business or business interests are outside the jurisdiction of eThekweni Municipality, a copy of the accounts/agreements from the relevant municipality must be attached (to the back inside cover of this document).
- Where the tenderer's Municipal Accounts are part of their lease agreement, then a copy of the agreement, or official letter to that effect is to be attached (to the back inside cover of this document).

Tenderers are to be include, at the back of their tender submission document, a printout of the above account's and or agreements signed with the municipality.

Failure to include the required document will make the tender submission non-responsive.

NAME (Block Capitals): _____ **Date** _____
SIGNATURE: _____

REU MBD 17: DEVELOPMENT PROPOSAL

Bidders are required to submit a concise development proposal for the site. The development proposal must include a concept Site Development Plan, an Architectural concept of the proposed development, proposed tenancing and preservation of the natural environment.

The development proposal must contain the following:

Proposed land use	Total Floor area (m2)
Totals	

1.2 Proposed improvements summary (if any)

Use	Total Floor area (m2)
Totals	

1.3 Estimated Cost of Development.

A breakdown of all costs to be incurred by the bidder in the preparation of the site must be provided. The cost provided in this section will form a critical part of the evaluation of proposals and will be a contractual condition of the development agreement awarded.		
No	Item Description	Estimated cost (Including vat)
1	Civil and Electrical Services	R
2	Civil Works	R
3	Top Structure (Building) Costs	R
4	Professional Fees	R
5	Sundry Development Costs	R
6	External/Bulk Services Contributions	R
7	Other	R
8	Totals	

1.3 Estimated development time frames

Estimated time, in months, from date of signature of lease agreement to date of start of construction.	Months
Estimated time, in months, from start of redevelopment/ refurbishment to completion of construction.	Months

REU MBD 18: SUSTAINABILITY MODEL (FUNDING/ DONOR/ SPONSOR)

Ideas in sourcing and growing the following aspects: <ul style="list-style-type: none">- Membership- Subsidy- Sponsor- Donation- Fund Raising- Bank Institution	
--	--

REU MBD 19: PUBLIC/SOCIAL BENEFIT PROPOSAL

It is a requirement that bidding entity or individual should demonstrate the following social benefits:

1. Demonstrate how the development will benefit disadvantaged communities, youth, women and people with disabilities	
2. Demonstrate how the development will benefit the local community and/or community based organisations	

REU MBD 20: PROPOSED EMPOWERMENT PLAN

FRAMEWORK FOR ACCELERATING ECONOMIC EMPOWERMENT AND TRANSFORMATION

1. EThekwini municipality is and will remain deliberate about transformation and its economic empowerment goals and is committed to the empowerment agenda.
2. The successful bidder will be required to champion the entrenchment of true economic transformation and empowerment in its spheres of influence. The successful bidder will be required to go beyond redressing historical imbalances and towards intrinsic true value that will result in active deliberate facilitation of sustainable and meaningful participation of Black people in the mainstream of the economy through its assets, investments and projects.
3. The bidder will be required to commit to the achievement of the following specific targets by completing the table below. The commitments made on the table below will be measured against the targets and used in the evaluation of the functional compliance evaluation. The commitments made in this table will form part of the contractual obligations of the successful bidder:

EMPOWERMENT TARGETS

DESCRIPTION	TARGET	Bidders Commitment numbers persons	in of
Job Creation & Job intensive plan			
Total number of jobs to be created during construction	Total jobs created		
Total number of jobs to be created after construction	Total jobs created		
Training & Development programme			
Training and Development Programmes (throughout the lifecycle of the project)	60% of workforce		
Rand value of spend to local SMMEs that have black ownership	50% of project value		
Full use of locally sourced or locally assembled material and/or products	70% of project value.		
Procurement of Material from Local Suppliers	30% of project value		
Enterprise Development Enterprise (during and after construction)			
Mandatory requirement in line with paragraph 5.12.4 of the eThekwini Municipality Land Disposal and Granting of Rights Policy, 2019 read together with paragraph 52 (21) (e) of the eThekwini Municipality: Supply Chain Management Policy, 2023.	Subcontracting a minimum of 30% of the Construction Cost to companies owned costs to local companies that 51% Black owned).		
Partnership with Women, Youth, and People with disabilities owned Companies	Total jobs number of Companies		
Demonstrate how the development will benefit the local community and/or community-based organisations			

REU MBD 21: EXPERIENCE AND CAPABILITIES OF BIDDER

- a) Details of proposed team including relevant experience and qualifications.
- b) The team must be appropriately qualified.
- c) Provide CVs and certified copies (copy with original stamp) of their relevant qualifications etc.

Details of experience completed by professional team.				
(PLEASE EXPAND TABLE IF REQUIRED) NB: DO NOT ATTACH A SEPARATE TABLE				
DISCIPLINE & Name of team member	EMPLOYER/ CLIENT	NATURE OF WORK	VALUE OF WORK	Client & contact Numbers
Architect				
Quantity Surveyor				
Engineers (civil and electrical)				
Project Manager				

THE BIDDER MUST INCLUDE TRACABLE REFERENCES FOR EACH PROFESSION.

<p>Construction Team Relevant Company Experience and References (a) Construction Team Bidder to submit, profiles, experienced and qualifications (with a minimum of 3 years' experience) (b) Main contractor- Evidence of at least 3 or more Completed Projects of a similar nature (i.e. Development/ Building Conversion/Refurbishment - Certificate of completion or traceable reference letters must be attached for project of similar nature.</p>				
<p>Main contractor- Evidence of at least 3 or more Completed Projects of a similar nature (i.e. Development/ Building Conversion/Refurbishment - Certificate of completion or traceable reference letters must be attached for project of similar nature.</p>				
No	PROJECT SUMMARY / SCOPE	START DATE – END DATE	PROJECT VALUE IN RANDB	CONTACTABLE REFERENCE INFORMATION
1				
2				
3				
4				
5				
<p>Construction Team Bidder to submit profiles, experience and qualifications (with a minimum of 3 years' experience)</p>				
DISCIPLINE & Name of team member	EMPLOYER/ CLIENT	NATURE OF WORK	VALUE OF WORK	Client & contact Numbers
Site Manager				

Registered Health & Safety Officer				
Social Facilitator				

REU MBD 22: ACCESS TO FUNDING

The bidder must submit proof of availability of 100% of the funding required for the development as per MDB 17.

Please note that the following definitions will be used in assessing the proof of availability of finance:

Proof of available funds qualifies as a letter/ expression of interest from a registered funder with Financial Sector Conduct Authority (FSCA) on an official letter head confirming the bidder's ability to access the funding required for the proposed development.

Provide funding model to incorporate how and where the funding will be sourced/raised and it must include collateral to be pledged against such funding if required.

Development Cost (Total Investment Value)

Total Development Cost	R
Debt Finance	R
Equity Investments (if any)	R
Source of Debt Finance <ul style="list-style-type: none"> Letter confirming access to debt funding 	
Source of Equity Finance <ul style="list-style-type: none"> Written confirmation of equity funding (Note: this source may not be a bank loan).	

ANNEXURE A : DEMOGRAPHIC PROFILE

DEMOGRAPHIC PROFILE APPLICABLE TO OBJECTIVE CRITERIA

Current demographic profile of 160 existing leases- Metro Wide

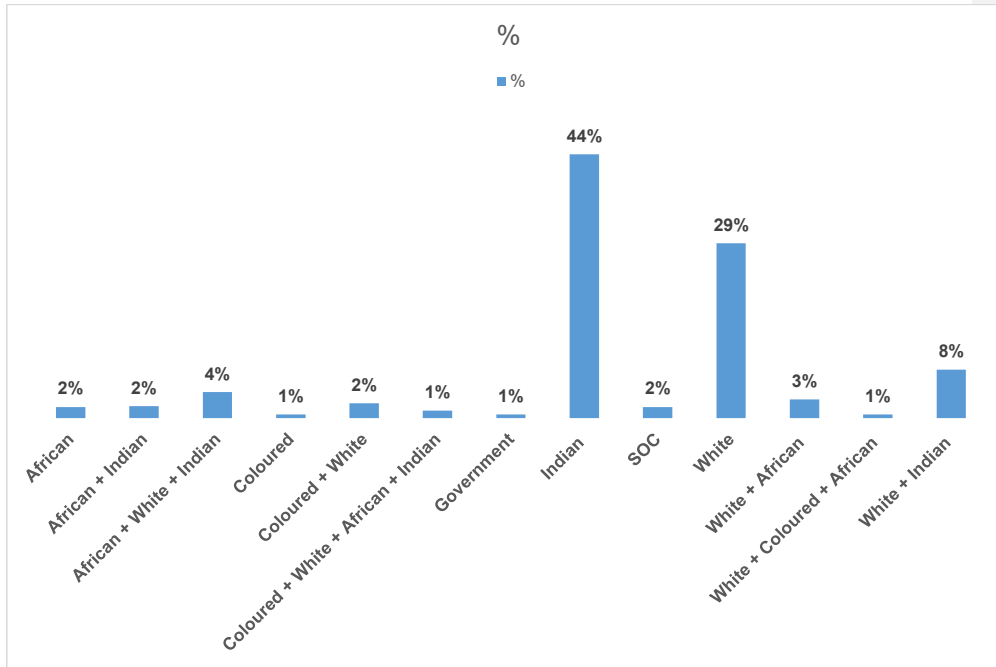

In instances where the leased premises is currently vacant the historic demographic profile was used .

ANNEXURES

COUNCIL DECISION – 29 APRIL 2021

- 2.15 Proposed Long-Term Lease of Erf 2586 of Mobeni Situated at Warrington/Leicester Roads for Commercial Purposes as Depicted on SJ Plan No. 4744/6A (17/2/1/2/5)
(Page 268 : Human Settlements and Infrastructure Committee - Agenda 2021-05-24)

COMMITTEE RECOMMENDS:

- 2.15.1 That approval be granted for the right to use control, or manage the capital asset described as proposed lease on Erf 2586 of Mobeni Registration Division FT in the Durban Entity Province of KwaZulu-Natal, measuring 1969m² as depicted on Hand Plan SJ Plan No 4744/6A, in terms of Regulation 34(1)(b) read together with Regulations 36 and 41 of the Municipal Asset Transfer Regulations (MATR), for a period of 9 years and 11 months that:
- 2.15.1.1 The land described as proposed lease of Erf 2586 Mobeni Registration Division FT in the Durban Entity Province of KwaZulu-Natal in extent of 1960m² as depicted on SJ Plan No. 4744/6A be leased by way of public tender at R29 400.00 (Twenty Nine Thousand Four Hundred Rand), per month, excluding VAT, for a period of 9 year and 11 months; and
- 2.15.1.2 The current market rental value of the land is currently assessed at R29 400.00 (Twenty Nine Thousand Four Hundred Rand), per month, exclusive of VAT.
- 2.15.2 That all cost incidental to the transaction shall be at the cost of the Lessee to whom the right to use, control or manage the capital asset is to be granted.

- 24 -

(eThekweni Municipality
Council Decisions - 2021-05-27)

- 2.15.3 That all developmental plans must be submitted to the Local Authority for approval to any construction.
- 2.15.4 That the site be used for commercial purposes and be suitable fenced and no advertising will be allowed on the fence.
- 2.15.5 That the Municipality must have the right of entry upon the land at all times for inspection purposes to construct services and maintain services without the Lessee having the right to claim for any damages which may occur.
- 2.15.6 That no encroachment over Municipal sewer servitude/sewer line permitted.
- 2.15.7 That prior to any development being done a plan must be submitted for approval.
- 2.15.8 That the Head: Real Estate be granted authority to sign all documents necessary to give effect to this transaction in terms of the Supply Chain Management Policy of the Municipality and any other applicable legislation, and that it shall be further subject to such additional conditions as the Head: Real Estate considers necessary to protect Municipal interest.

ADOPTED.