

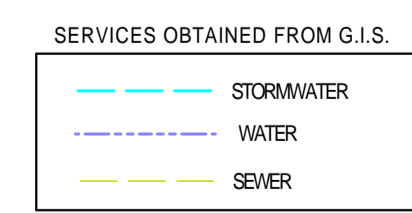

CO-ORDINATE SYSTEM WG31 BASED ON WGS 84 ELLIPSOID

NWME	Y	X	Z	DESCRIPTION
NH1	+ 16 360.326	3 300 646.766	358.354	Nail in Tar
NH2	+ 16 300.984	3 300 647.370	357.808	Nail in Tar
NH3	+ 16 296.097	3 300 670.504	357.692	Nail in Tar
NH4	+ 16 357.819	3 300 681.565	357.953	Nail in Tar

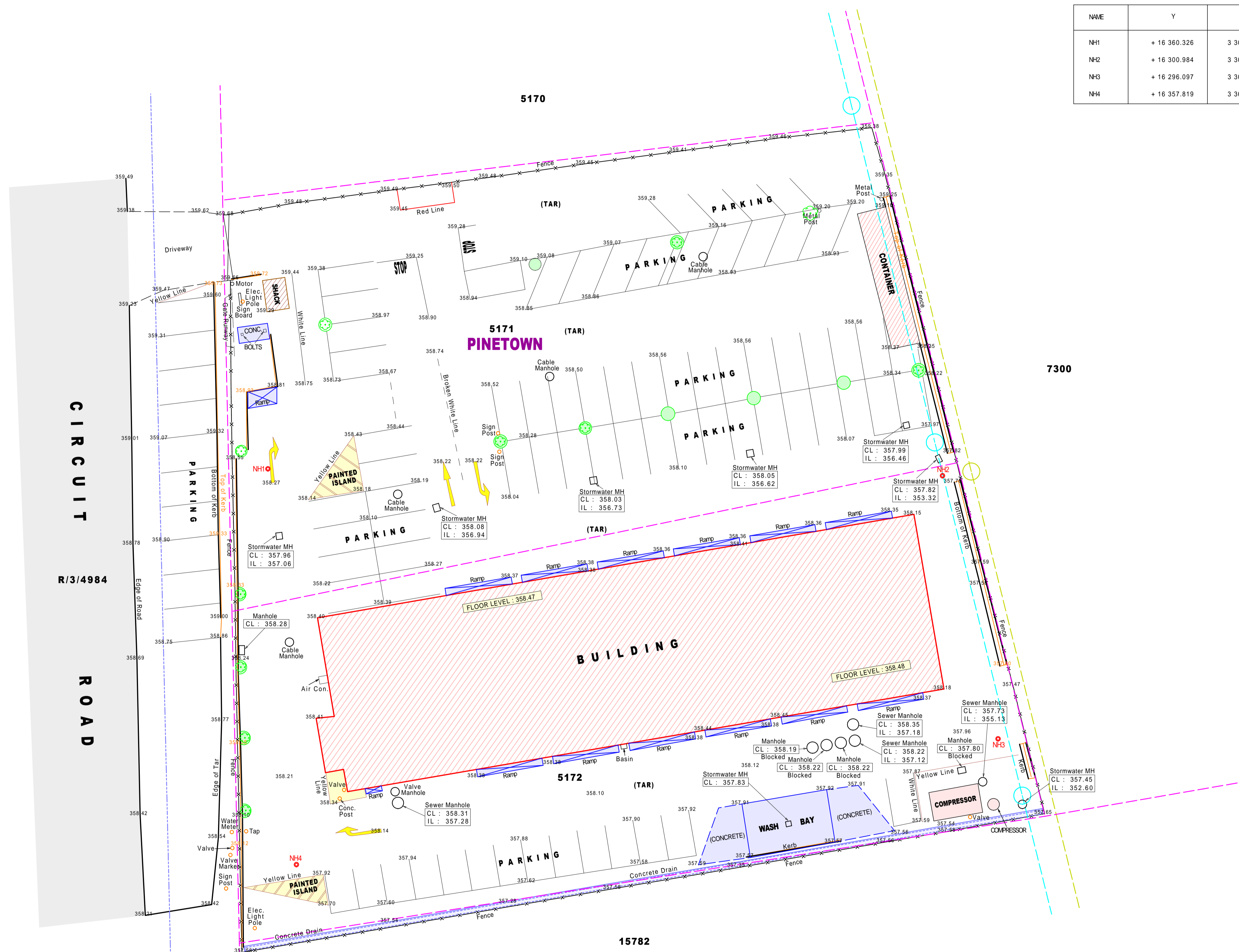

ETHEKWINI MUNICIPALITY - SURVEYING AND LAND INFORMATION DEPT - ENGINEERING UNIT

DETAIL SURVEY 6 CIRCUIT ROAD - WESTMEAD

SURVEYED BY	N.Ndaba	PLAN No.	E2012-024
DRAWN BY	B.Govender	SURVEY No.	E2012-024
SCALE	1:200 - A1	JOB No.	WQ 1612446
DATE	March 2012	APPROVED BY	
		INDEX	